

RERA Approved: HRERA-PKL-JJR-463-2023



दीन दयाल जन
आवास योजना



Shree Krishna Heritage

The Future of NCR Living.

Where Vision Meets Value

Shri Krishna Heritage is a premium plotted development in Sector 9A, Jhajjar, designed for those who value luxury, independence, and future-ready living.



- Spread across 5.01 acres of planned residential development
- Premium plots with Stilt + 4 floor approval
- Located near KMP Expressway for seamless NCR connectivity
- Close to AIIMS Jhajjar and Reliance MET City
- Secure gated community with modern infrastructure
- Ideal for both end-use and long-term investment

A perfect blend of location, lifestyle, and legacy.

At the Crossroads of Connectivity

◎ Direct connectivity via KMP Expressway

◎ Quick access to Delhi & IGI Airport



◎ Near Reliance MET City industrial hub

◎ Close to National Cancer Institute (AIIMS)

◎ Direct connectivity to Kharkhoda & Sonipat

Where your home meets the world.



Architectural Autonomy

Approved for Stilt + 4 Floors
Ideal for multi-generational living
High potential for rental income
Independent floor registry
Rainwater harvesting system
Sewage Treatment Plant (STP)

Peace of Mind, Guaranteed



Peace of Mind, Guaranteed

24/7 security with trained personnel
CCTV surveillance

High boundary walls for privacy

9-meter wide internal roads

Underground electrification
fiber network



Designed for Perfection

- Green parks & open spaces
- Total land area: 5.01 Acres
- Well-planned layout
- Dedicated commercial area

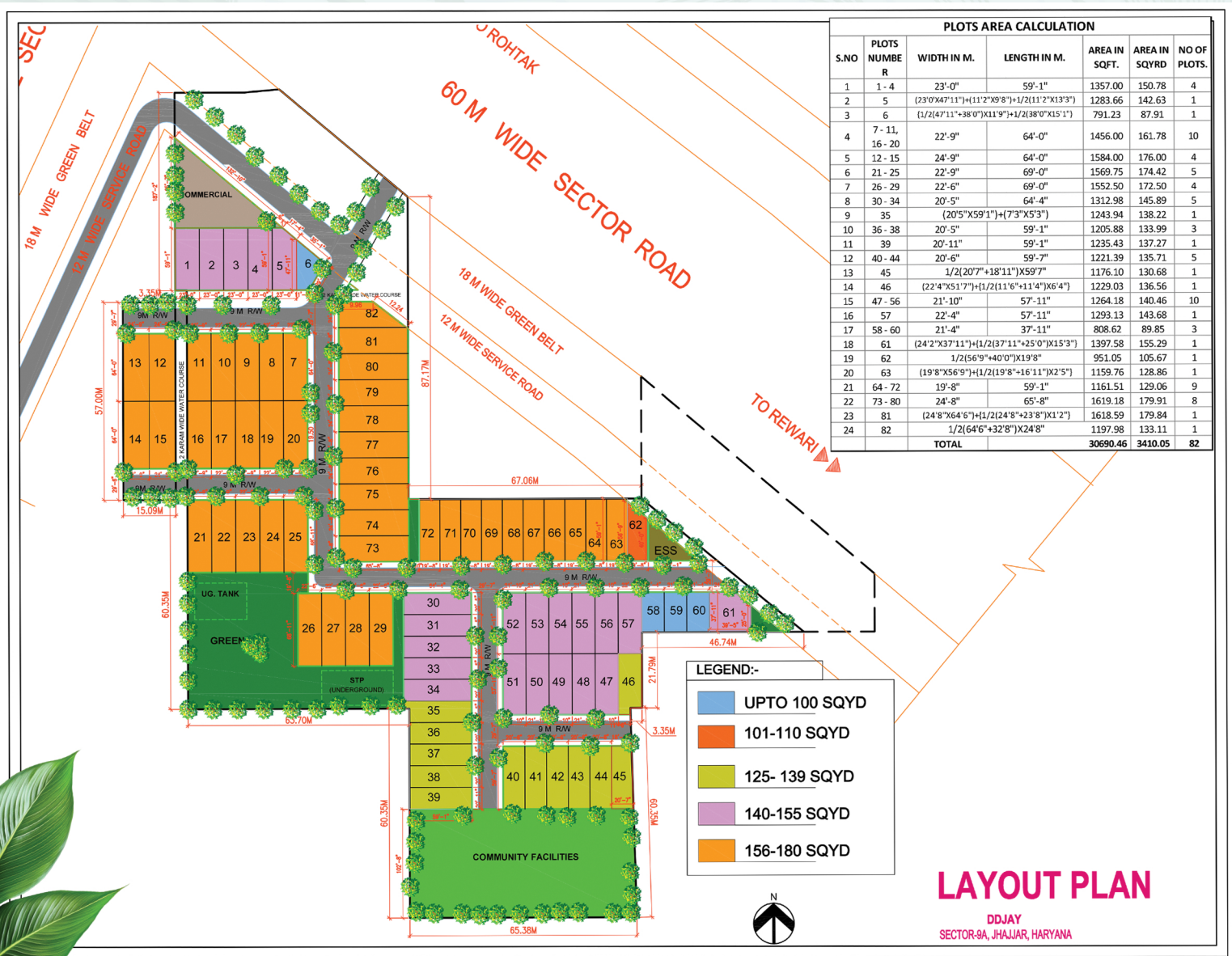

Priced for the Future.



Up to 80% home loan available

PRICE LIST & PAYMENT PLAN

SHREE KRISHNA HERITAGE

HRERA No.: HRERA-PKL-JJR-463-2023

(DEEN DAYAL JAN AWAS YOJNA PLOTS)

Unit Size (Sq.yd)	Unit Price (in ₹ Per Sq.yd.)	Registration Amount	10% On Allotment	90% Offer of Possession/Registry + include 100% EDC/IDC	Total Cost*
135.71	55000.00	29000.00	717405.00	6880497.00	7626902.00
140.46	55000.00	29000.00	743530.00	7121322.00	7893852.00
161.78	55000.00	29000.00	860790.00	8202246.00	9092036.00
172.50	55000.00	29000.00	919750.00	8745750.00	9694500.00

Applicable for Management Quota Only

Terms & Conditions*

1. Cheque in Favour of "M S Kharb Infra Build LLP"

Bank Detail : INDIAN OVERSEAS BANK , Najafgarh, New Delhi, Bank Account Number : 22610200000539 IFSC Code : IOB.

2. EDC & IDC Charges : Rs. 1200/- per sq.yd.

3. PLC as Applicable.

4. BBA & Registry Charges as applicable will be extra.

The time to invest in the next Gurugram is now. Join the visionary families who are calling Shri Krishna Heritage home.



Visit Us:

-  Sector 9A, Jhajjar, Haryana
-  +91 9211 498 111
-  deendayaljanawasyojanajhajjar.com
-  info@deendayaljanawasyojanajhajjar.com

